

City Max: SCL (CP/PT/SE)

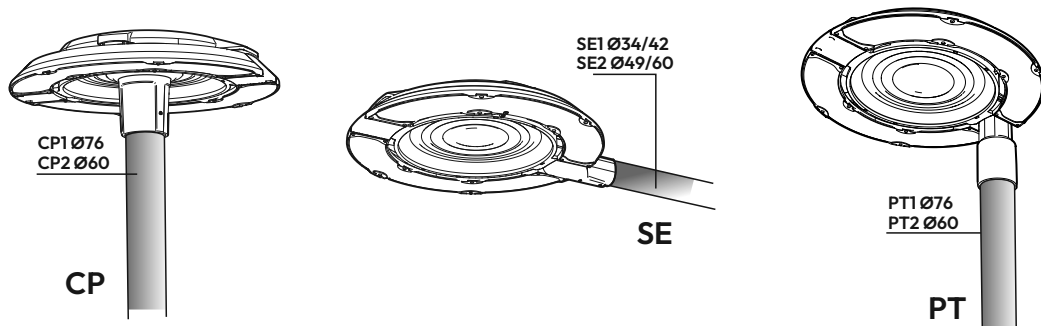

CP

PT

SE

MOD1

MOD2

Mod.	Kg.
SE2/PT2 MOD1	10,00
SE2/PT2 MOD1+MOD2	12,60
CP2 MOD1	10,16
CP2 MOD1+MOD2	12,70

weight (electrical controls)
peso (con controles eléctricos)
poids (avec commandes électriques)
gewicht (elektronisch drivers)

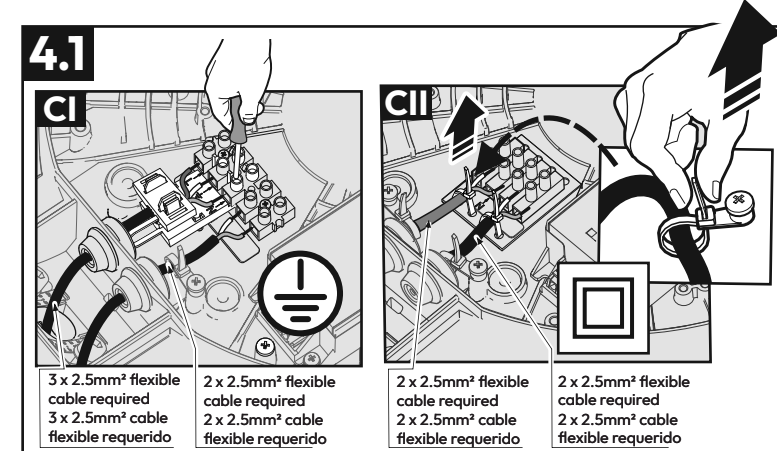
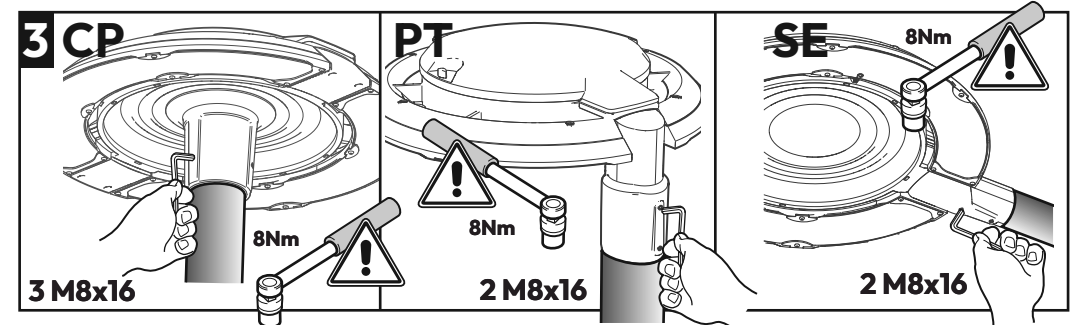
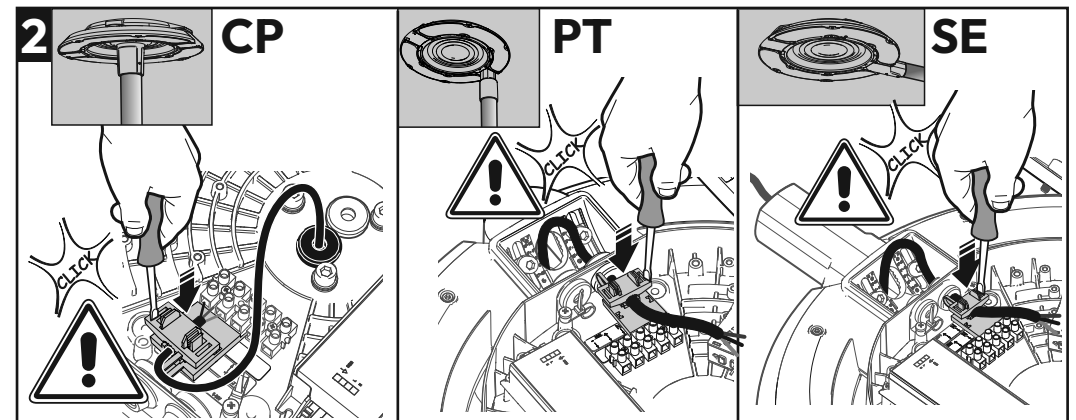
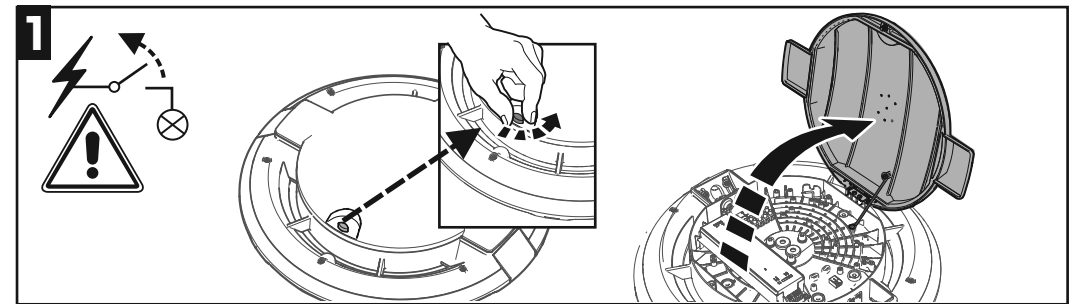

City Max: SCL VB1/VB2 & CB1/CB2

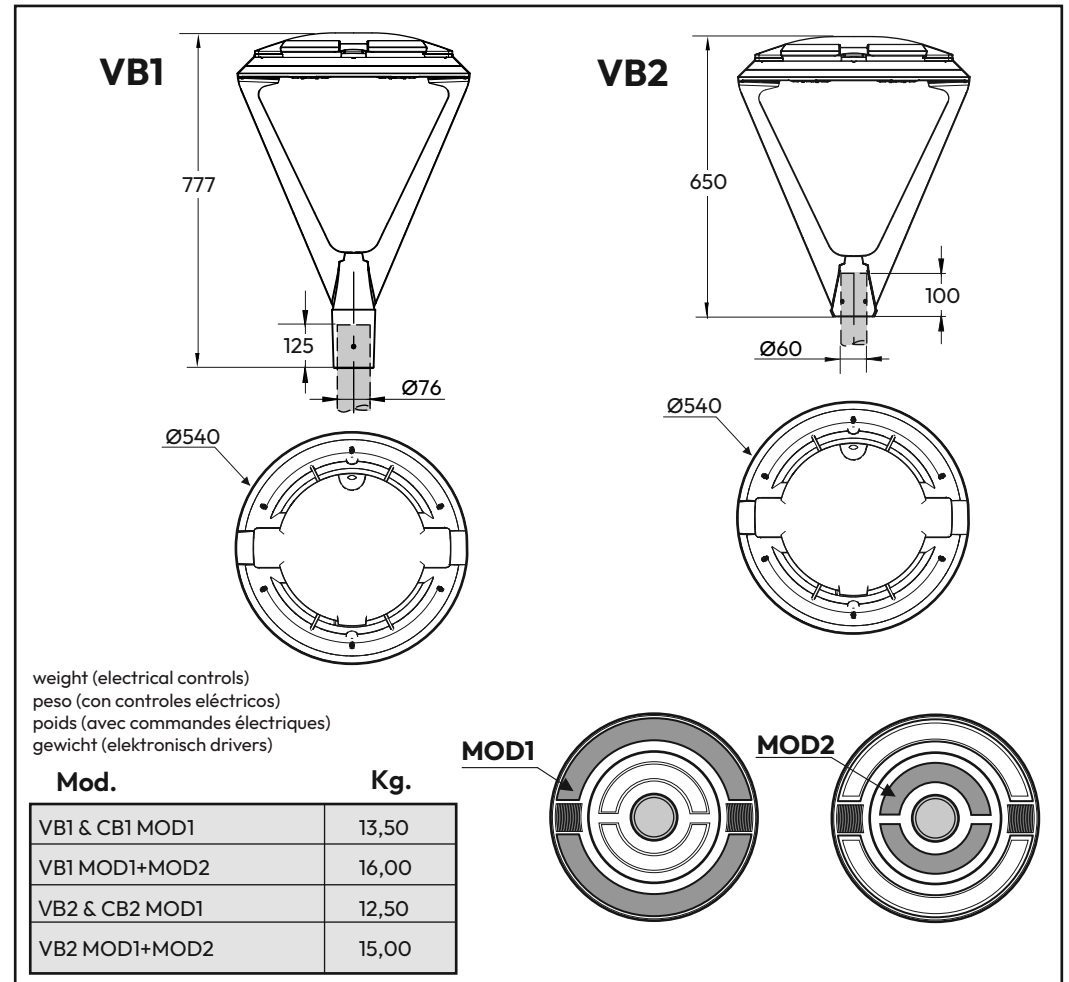
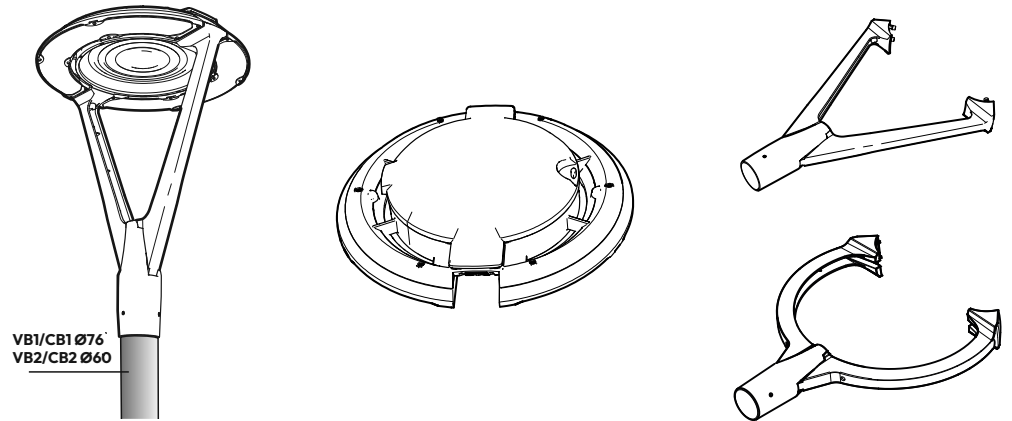
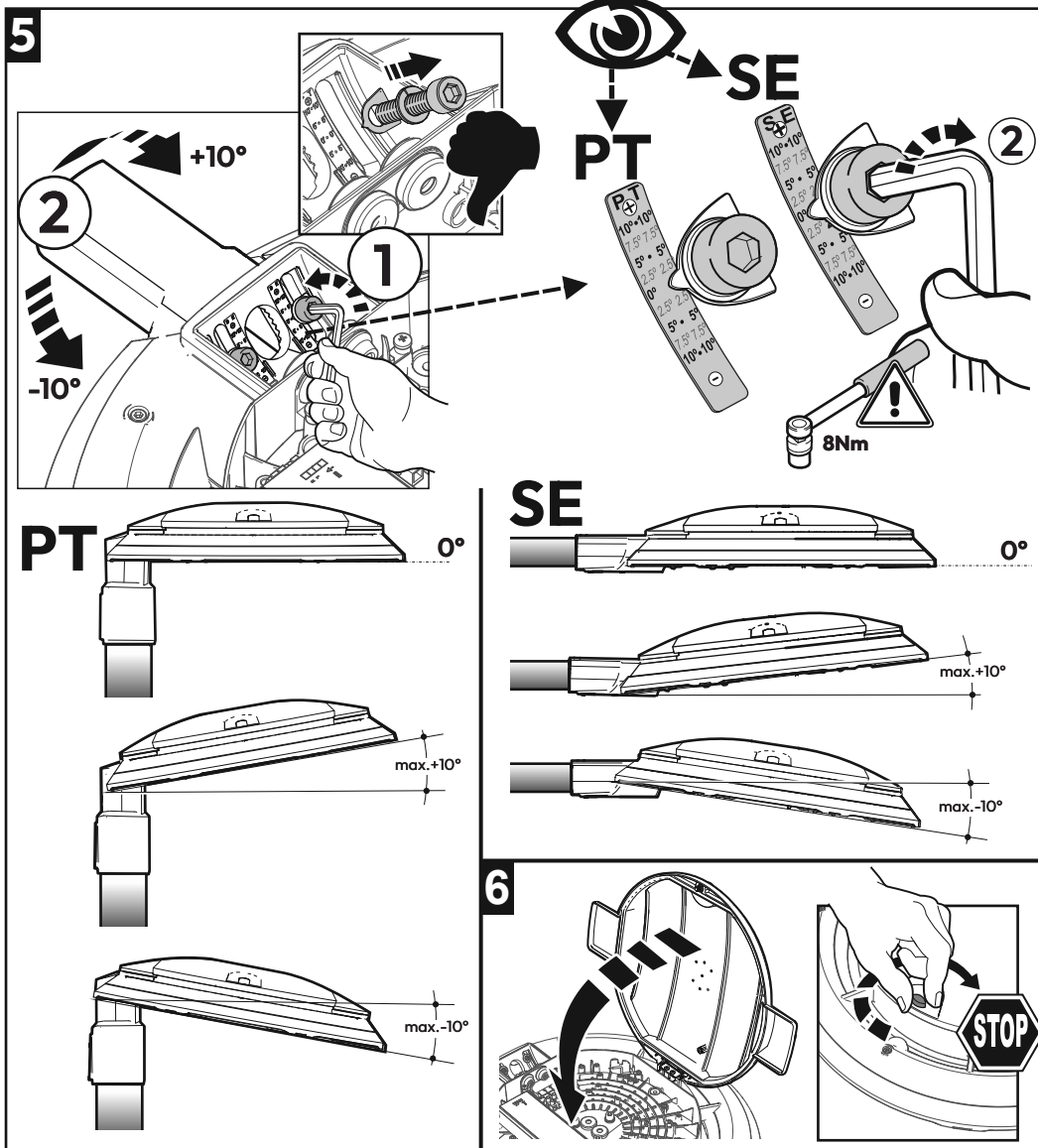
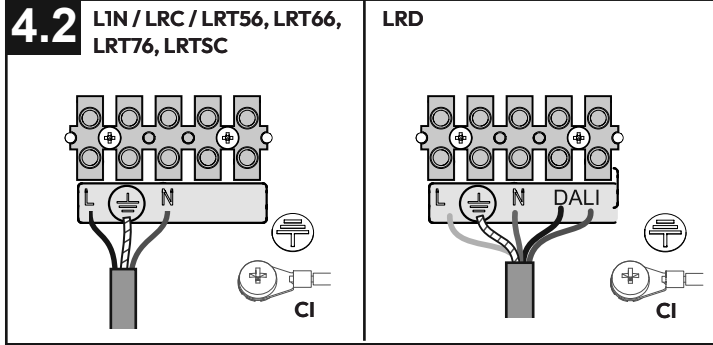

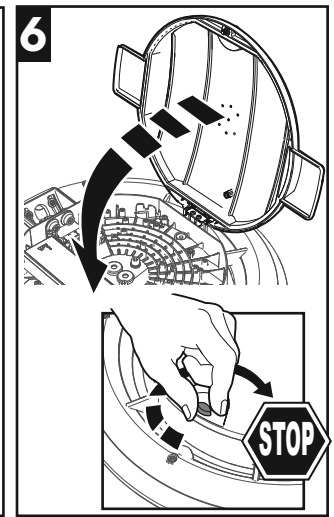
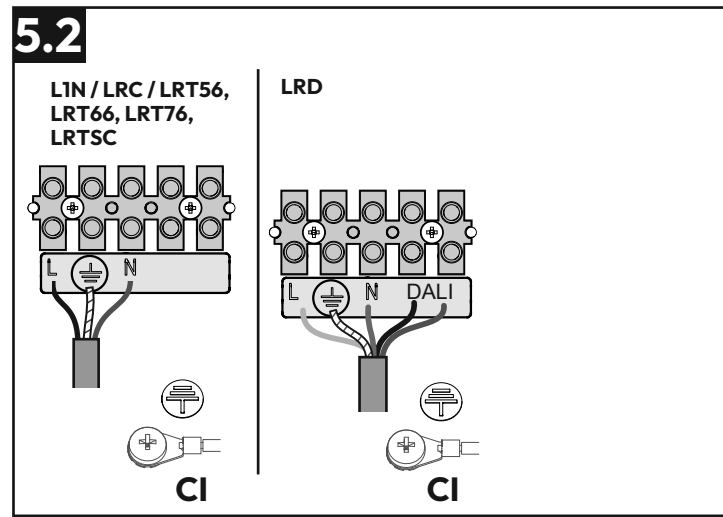
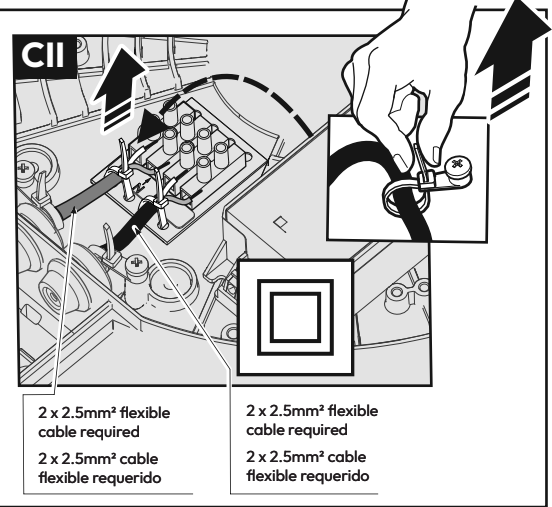
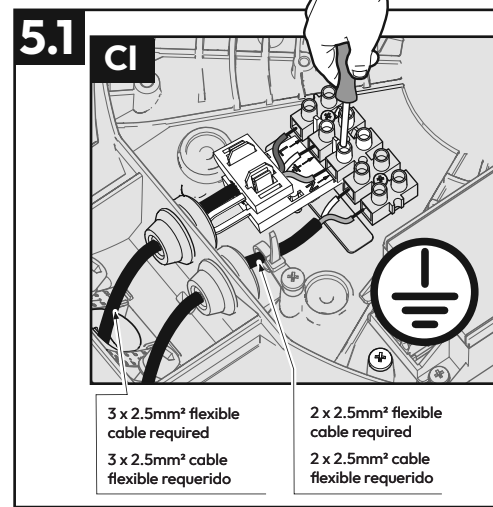
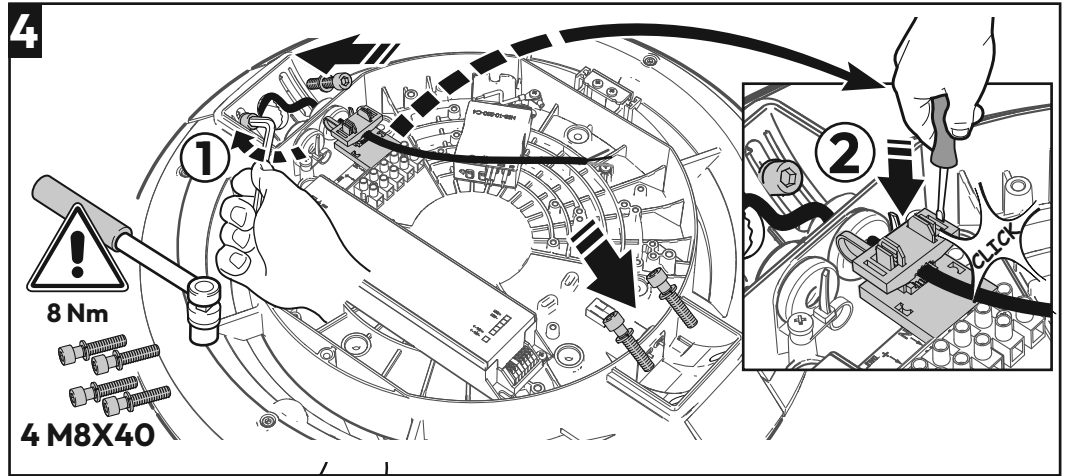
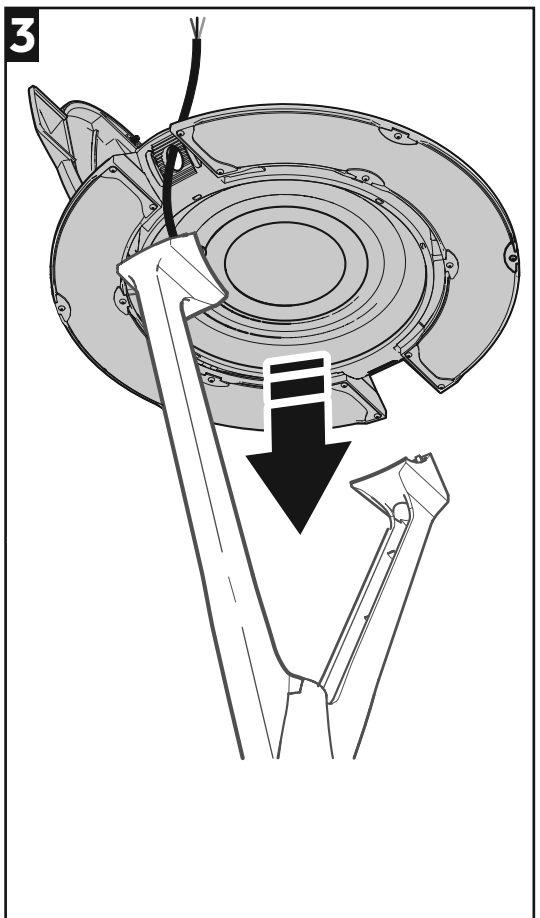
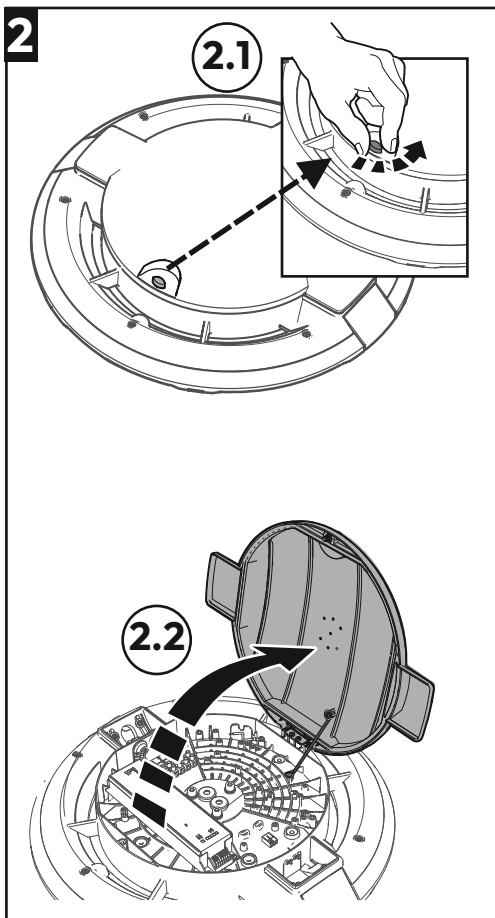
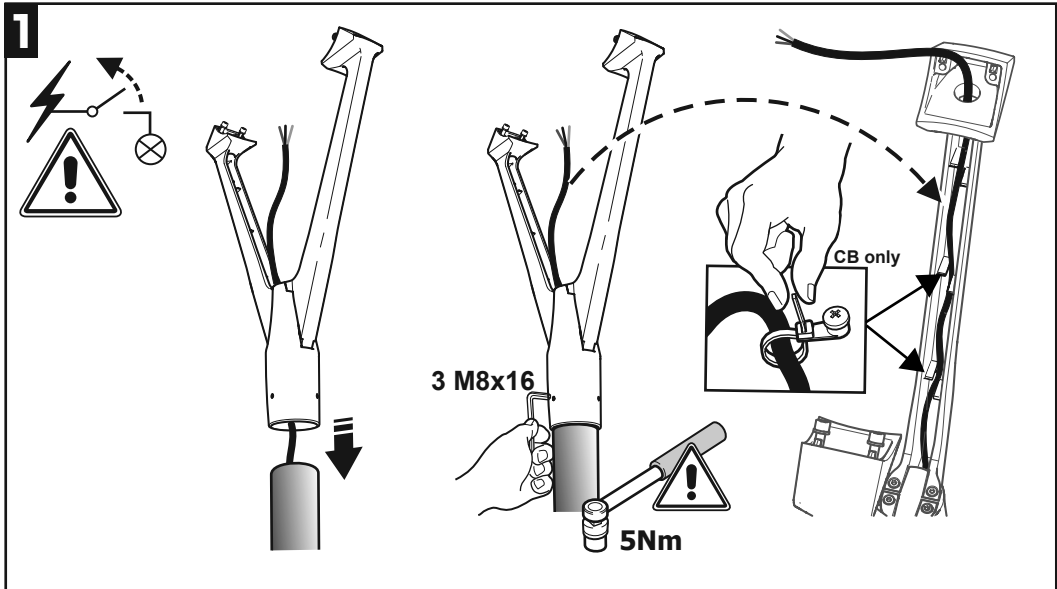

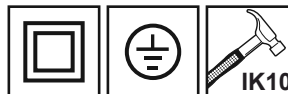
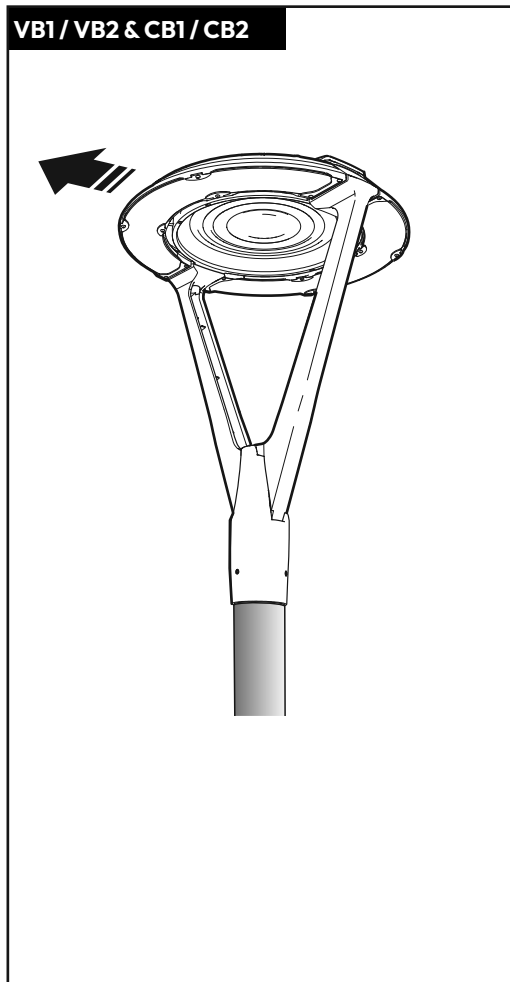
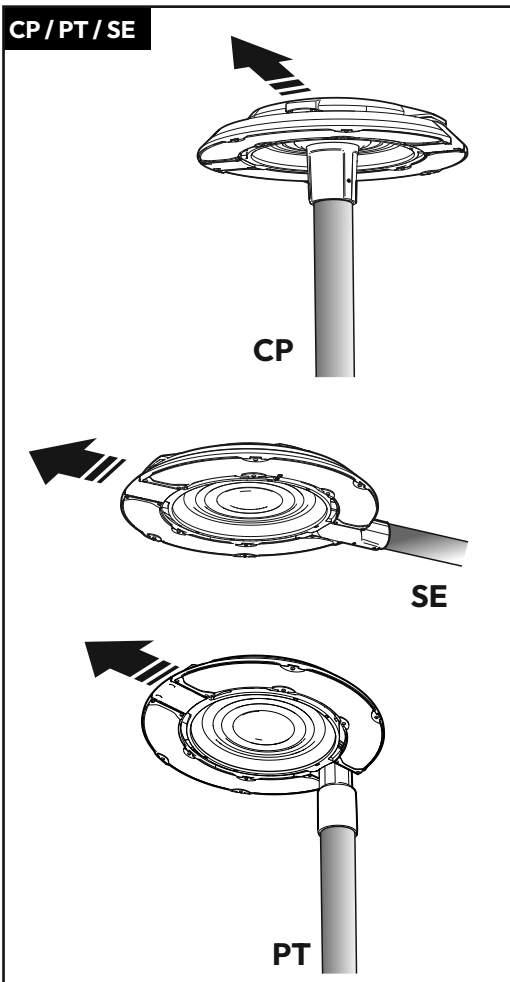
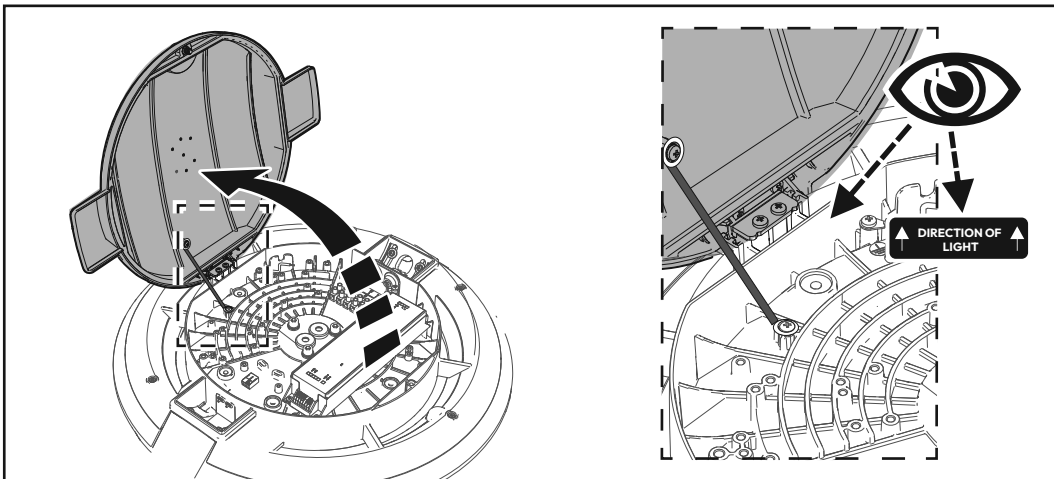

Gear Compartment	Controls/ Photocells	Light Engine
IP66	IP65	IP66

